

# RACCORDI A CALZAMENTO PVDF

## PLUS

**OTTIMO SISTEMA DI SERRAGGIO CON  
IL DADO DI CHIUSURA**

---

**AMPIO RANGE DI TEMPERATURA**

---

**FACILE DA USARE ED ESTREMAMENTE  
FORTE**

---

**ALTISSIMA TENUTA DEL TUBO**

---

**ALTA RESISTENZA CHIMICA**





p. 212 / **2900**



p. 212 / **2905**



p. 212 / **2910**



p. 213 / **2915**



p. 213 / **2930**



p. 213 / **2935**



p. 213 / **2940**



p. 214 / **2950**



p. 214 / **2955**



p. 214 / **2960**



p. 214 / **2965**



p. 215 / **2970**



p. 215 / **2230**



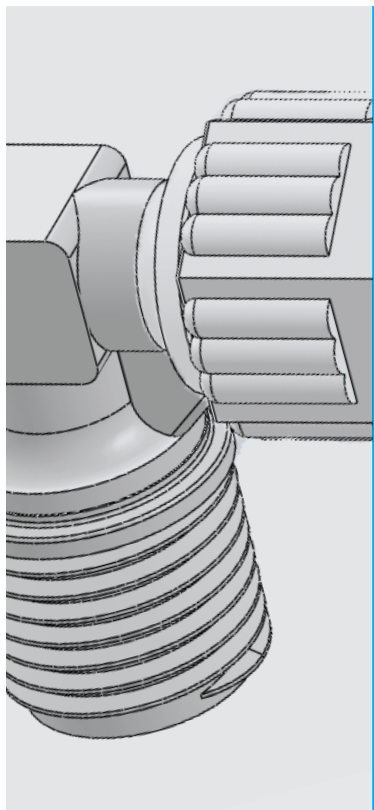

-20°C ÷ +120°C  
a seconda dell'applicazione



Fino a 14 Bar a 20°C



Aria compressa, acqua e fluidi  
compatibili con i materiali costruttivi



Conica gas BSPT ISO 7  
da R1/8" a R3/4"



Poliuretano, Polietilene, Poliamide,  
PTFE, FEP



**Corpo:** Fluoruro di polivinilidene (PVDF)

**Dado:** Polipropilene

**O-Ring:** Silicone

Disponibile a richiesta filetti NPT  
con tubo in pollici



Prodotti conformi alla  
direttiva 2002/95/EC

**RoHS2**

Prodotti conformi alla  
direttiva 2011/65/EU



## PRECAUZIONI

- I raccordi di questa serie hanno il filetto in plastica e di conseguenza si consiglia di evitare una forza eccessiva durante l'avvitamento e di teflonare il filetto prima dell'utilizzo in modo tale da prevenire eventuali perdite.
- Si consiglia di inserire il tubo in battuta e di serrare bene il dado prima dell'utilizzo.
- Tagliare la parte di tubo agganciata al raccordo per poterlo riutilizzare

## COPPIA DI SERRAGGIO CONSIGLIATA

FILETTATURA	NM	FT LB
1/8	0,1	0,07
1/4	1	0,8
3/8	5	3
1/2	8	6
3/4	16	12

## MISURA CRESTA

Ø	MM
Ø6	6,2
Ø8	7,2
Ø10	9,2
Ø12	12



2900

Diritto maschio cilindrico BSPP con OR

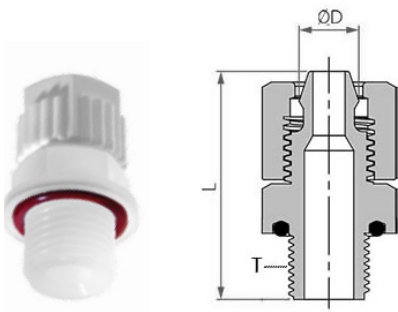

CODE	ØD	T	L	GR.
2900TR186	6/4	G1/8"	27,2	4,14
2900TR146	6/4	G1/4"	30,9	5,37
2900TR188	8/5,5	G1/8"	27,3	4,09
2900TR148	8/5,5	G1/4"	31,1	5,9
2900TR1810	10/7	G1/8"	27,2	-
2900TR1410	10/7	G1/4"	31,0	-

2905

Diritto femmina conico BSPT

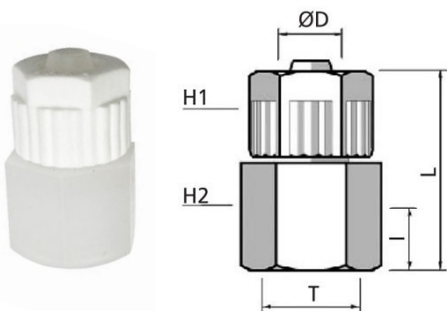

CODE	ØD	T	I	L	H1	H2	GR.
2905TR186	6/4	R1/8"	10,0	26,3	14	14	3,0
2905TR146	6/4	R1/4"	11,0	28,0	14	17	3,0
2905TR188	8/5,5	R1/8"	9,0	26,3	14	14	3,0
2905TR148	8/5,5	R1/4"	11,0	28,0	14	17	4,0
2905TR388	8/5,5	R3/8"	11,2	30,5	14	22	5,0
2905TR128	8/5,5	R1/2"	13,5	32,5	14	26	6,0
2905TR1410	10/7	R1/4"	10,0	32,0	17	17	6,0
2905TR3810	10/7	R3/8"	11,0	33,5	17	22	7,0
2905TR1210	10/7	R1/2"	13,8	35,5	17	26	7,0

2910

Diritto maschio conico BSPT

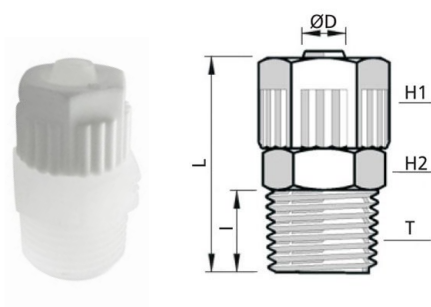

CODE	ØD	T	I	L	H1	H2	GR.
2910TR186	6/4	R1/8"	8,0	27,0	14	13	3,0
2910TR146	6/4	R1/4"	10,5	30,0	14	15	3,0
2910TR386	6/4	R3/8"	10,5	27,0	14	18	6,48
2910TR126	6/4	R1/2"	13,0	31,5	14	22	6,0
2910TR346	6/4	R3/4"	9,0	23,0	14	27	8,0
2910TR188	8/5,5	R1/8"	8,0	27,0	14	13	3,0
2910TR148	8/5,5	R1/4"	10,5	30,0	14	15	3,0
2910TR388	8/5,5	R3/8"	10,5	31,5	14	18	4,0
2910TR128	8/5,5	R1/2"	13,0	34,0	14	22	5,0
2910TR348	8/5,5	R3/4"	9,0	27,5	14	27	8,0
2910TR1410	10/7	R1/4"	10,5	36,0	17	17	4,0
2910TR3810	10/7	R3/8"	10,5	36,0	17	17	5,0
2910TR1210	10/7	R1/2"	12,0	39,0	17	22	6,0
2910TR3410	10/7	R3/4"	13,0	40,0	17	27	6,0
2910TR1412	12/9	R1/4"	10,5	34,0	19	14	6,0
2910TR3812	12/9	R3/8"	10,5	36,0	19	18	7,0
2910TR1212	12/9	R1/2"	12,5	37,0	19	22	7,0
2910TR3412	12/9	R3/4"	13,0	34,0	19	27	15,64



2915

Diritto intermedio

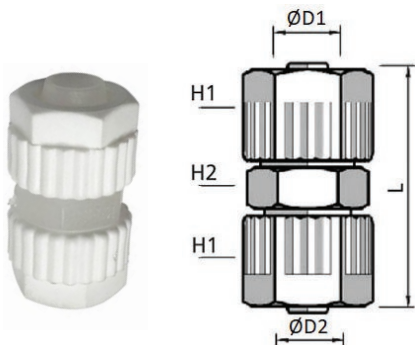

CODE	ØD1	ØD2	L	H1	H2	GR.
2915TR6	6/4	6/4	32,5	14	14	4,0
2915TR8	8/5,5	8/5,5	32,5	14	14	4,0
2915TR12	12/9	12/9	40,6	19	18	8,0
2915TR86	8/5,5	6/4	32,5	14	14	4,0

2930

Gomito femmina conico BSPT

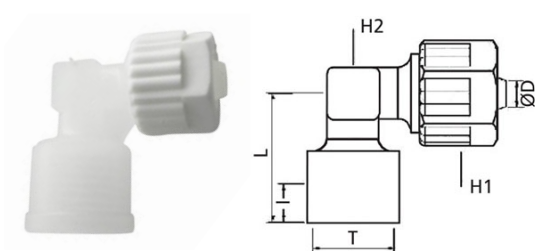

CODE	ØD	T	I	L	H1	H2	GR.
2930TR186	6/4	R1/8"	10,5	19,5	14	9	5,0
2930TR146	6/4	R1/4"	12,3	22,5	14	9	5,0
2930TR148	8/5,5	R1/4"	12,3	22,5	14	9	6,0

2935

Gomito intermedio

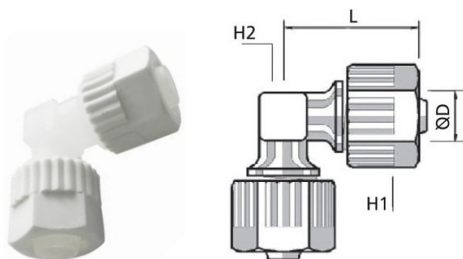

CODE	ØD	L	H1	H2	GR.
2935TR6	6/4	23,3	14	8	4,0
2935TR8	8/5,5	23,5	14	8	4,0
2935TR12	12/9	32,0	19	15	10,0

2940

Gomito maschio conico BSPT

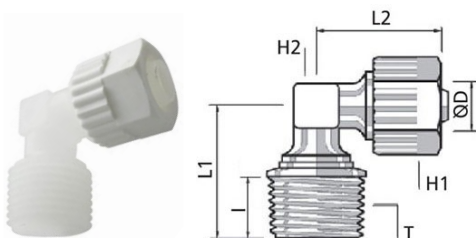

CODE	ØD	T	I	L1	L2	H1	H2	GR.
2940TR186	6/4	R1/8"	8,0	18,5	22,5	14	8	2,0
2940TR146	6/4	R1/4"	10,0	23,0	22,5	14	8	3,0
2940TR188	8/5,5	R1/8"	8,5	18,5	23,0	14	8	3,0
2940TR148	8/5,5	R1/4"	11,0	23,0	23,0	14	8	3,0
2940TR388	8/5,5	R3/8"	11,0	23,5	23,0	14	8	5,0
2940TR1412	12/9	R1/4"	10,0	24,0	33,0	19	15	7,0
2940TR3812	12/9	R3/8"	10,0	24,5	33,0	19	15	6,0
2940TR1212	12/9	R1/2"	13,0	28,5	33,0	19	15	9,0



2950

T femmina conico BSPT

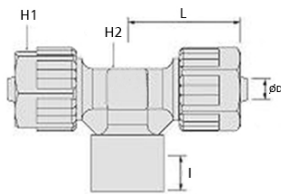

CODE	ØD	T	I	L	H1	H2	GR.
2950TR186	6/4	R1/8"	10,2	23,3	14	8	8,16
2950TR148	8/5,5	R1/4"	12,5	23,3	14	8	8,7

2955

T maschio conico BSPT

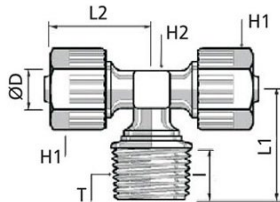

CODE	ØD	T	I	L1	L2	H1	H2	GR.
2955TR186	6/4	R1/8"	9,0	19,0	23,3	14	8	6,0
2955TR146	6/4	R1/4"	11,0	21,0	23,3	14	8	6,0
2955TR188	8/5,5	R1/8"	9,0	19,0	23,3	14	8	5,0
2955TR148	8/5,5	R1/4"	11,0	21,0	23,3	14	8	6,0
2955TR388	8/5,5	R3/8"	11,0	21,0	23,3	14	8	7,0
2955TR1412	12/9	R1/4"	11,0	21,0	23,3	14	8	12,0
2955TR3812	12/9	R3/8"	10,7	24,5	33,5	19	15	14,0
2955TR1212	12/9	R1/2"	15,0	28,5	33,0	19	15	15,0

2960

T laterale maschio conico BSPT

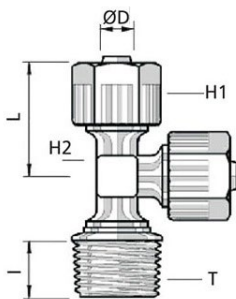

CODE	ØD	T	I	L	H1	H2	GR.
2960TR186	6/4	R1/8"	8,5	23,3	14	8	5,0
2960TR146	6/4	R1/4"	11,0	23,3	14	8	5,0
2960TR188	8/5,5	R1/8"	8,5	23,3	14	8	5,0
2960TR148	8/5,5	R1/4"	11,0	23,3	14	8	5,0
2960TR388	8/5,5	R3/8"	10,0	23,3	14	8	7,0
2960TR1412	12/9	R1/4"	10,0	33,0	19	15	12,0
2960TR3812	12/9	R3/8"	11,0	33,0	19	15	14,0
2960TR1212	12/9	R1/2"	15,0	33,0	19	15	15,0

2965

T intermedio

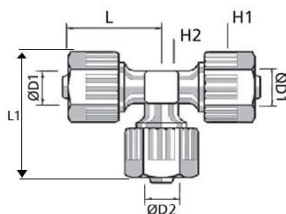

CODE	ØD1	ØD2	L	L1	H1	H2	GR.
2965TR6	6/4	6/4	22,0	27,5	14	8	7,0
2965TR8	8/5,5	8/5,5	22,0	27,5	14	8	5,0
2965TR12	12/9	12/9	32,0	40,4	19	14	14,0
2965TR68	6/4	8/5,5	46,8	27,4	-	-	8,73
2965TR86	8/5,5	6/4	46,8	27,4	-	-	8,96



## 2970

T maschio ridotto conico BSPT

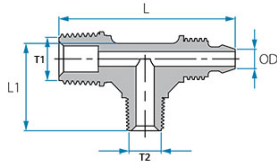

CODE	ØD	T1	T2	L	L1	GR.
2970TR148	8/5,5	R1/4"	R1/8"	46,2	22,6	7,15

## 2230

Dado di bloccaggio

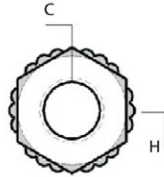

CODE	ØD	ØC	H	GR.
2230TR6	6/4	6,2	14	1,0
2230TR8	8/5,5	8,1	14	2,0
2230TR10	10/7	10,2	17	3,0
2230TR12	12/9	12,8	19	4,0

