

HEX HEAD BUSHING

*Réduction
mâle-femelle*

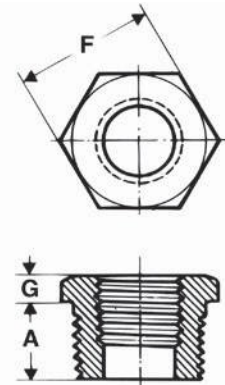

Class 3000 lbs. - 6000 lbs.
Dimensions: ASME B 16.11
Thread: ASME B 1.20.1

Nominal pipe size Diamètre nominal	3000-6000					
	A min		F nominal		G min.	
	inches	mm	inches	mm	inches	mm
3/8 x 1/4	0.50	13	0.69	17.46	0.16	4
1/2 x 3/8	0.56	14	0.88	22.23	0.19	5
1/2 x 1/4	0.56	14	0.88	22.23	0.19	5
3/4 x 1/2	0.62	16	1.06	26.99	0.22	6
3/4 x 1/4	0.62	16	1.06	26.99	0.22	6
1 x 3/4	0.75	19	1.38	34.93	0.25	6
1 x 1/2	0.75	19	1.38	34.93	0.25	6
1 x 1/4	0.75	19	1.38	34.93	0.25	6
1 1/4 x 1	0.81	21	1.75	44.45	0.28	7
1 1/2 x 1	0.81	21	2.00	50.80	0.31	8
1 1/2 x 3/4	0.81	21	2.00	50.80	0.31	8
1 1/2 x 1/2	0.81	21	2.00	50.80	0.31	8
2 x 1 1/2	0.88	22	2.50	63.50	0.34	9
2 x 1	0.88	22	2.50	63.50	0.34	9
2 1/2 x 2	1.06	27	3.00	76.20	0.38	10
3 x 2	1.12	28	3.50	88.90	0.41	10
4 x 3	1.25	32	4.62	117.48	0.50	13
4 x 2	1.25	32	4.62	117.48	0.50	13

SQUARE HEAD PLUG

*Bouchon mâle
tête carrée*

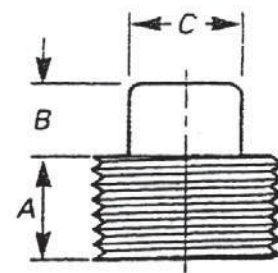

Class 3000 lbs. - 6000 lbs.
Dimensions: ASME B 16.11
Thread: ASME B 1.20.1

Nominal pipe size Diamètre nominal	3000-6000					
	A min		C nominal		B min.	
	inches	mm	inches	mm	inches	mm
1/8	0.38	10	0.28	7.15	0.25	6
1/4	0.44	11	0.38	9.55	0.25	6
3/8	0.50	13	0.44	11.11	0.31	8
1/2	0.56	14	0.56	14.29	0.38	10
3/4	0.62	16	0.62	15.88	0.44	11
1	0.75	19	0.81	20.64	0.50	13
1 1/4	0.81	21	0.94	23.81	0.56	14
1 1/2	0.81	21	1.12	28.58	0.62	16
2	0.88	22	1.31	33.27	0.69	18
2 1/2	1.06	27	1.50	38.10	0.75	19
3	1.12	28	1.69	42.86	0.81	21
4	1.25	32	2.50	63.50	1.00	25